



# Form Mould Services cc.

Phone: (011)953-3947/59  
 Fax: (011)953-4994  
 Email: sales@fms-sa.co.za

P.O. Box 5533  
 West Krugersdorp  
 1742

24 Carter Street  
 Delporton  
 Krugersdorp

## AIR VALVE

Ref.	A	B	C	D	E	H	M
VA.050412	5	3	12	1.5	4	7	2.5
VA.065212	6	5,2	12	1,5	4	7	0,95
VA.086512	8	6,5	12	1,5	4	7	0,95
VA.100812	10	8	12	2	8	7	0,95
VA.121012	12	10	12	2,5	10	7	0,95
VA.161320	16	13	20	3	12	12	1,55
VA.201720	20	17	20	3,5	16	12	1,55

● Cad Insertion Point

**IMPORTANT**  
 Reference VA.050412, do not include mechanical stop.

**Mat.: INOX. 1.4034**  
 Hardened  $51 \pm 3$  HRC.  
 Minimum working pressure 3 BARS.

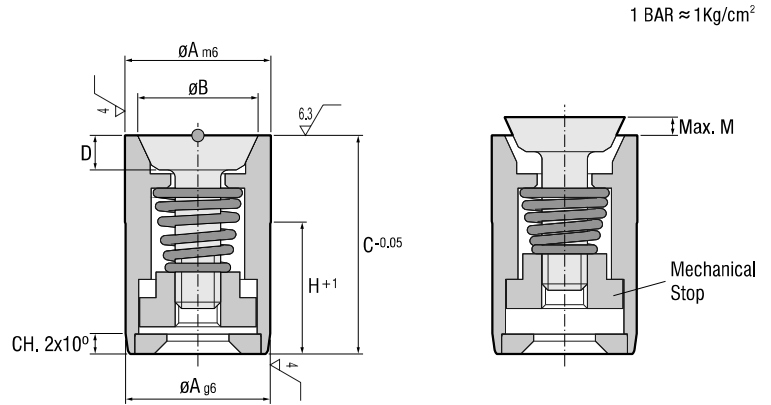

## FILTER VALVE

**Mat. INOX. 1.4034 - 48/54HRC.**  
 Working pressure 1.5 - 6 BARS.

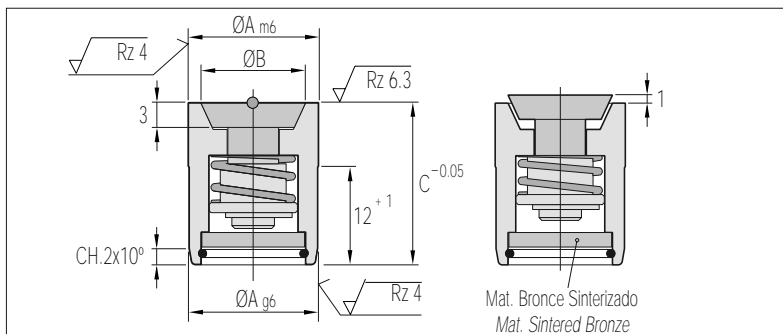

**Filter Valve.** Designed for use in thermoplastic molds incorporating a filter to ensure debris cannot affect the unit's correct function.

Ref.	A	B	C	E
FV.161320	16	13	20	14
FV.201720	20	17	20	18

## DOUBLE VALVE

**Mat. INOX. 1.4034 - 48/54HRC.**

**Double Valve.** An effective method of semi pneumatic ejection, for tools with ribs or areas forming gas traps or vaccum conditions.

Ref.	A	B	C	E	H
VD.080512	8	5	12	4	7
VD.100612	10	6	12	5	7
VD.120812	12	8	12	7	7
VD.161020	16	10	20	9	12

